

KTM 1290 SUPERDUKE GT '19-

M O U N T I N G I N S T R U C T I O N S

REF 3565

TOURING SCREEN WITH VISOR



ID.	PIEZA/PART	DESCRIPCIÓN	DESCRIPTION	QTY.	REF.:
1		Cúpula touring	Touring screen	1	3564HVIS
2		Tornillo especial M5x9 Long Hexagonal 14	M5x9 special screw Hexagonal Length 14	4	TORNI-EC----597
3		Silentblock Ø9xØ6x8mm	Ø9xØ6x8mm silentblock	4	AROPASACABLES-3
4		Casquillo con valona Ø12xØ6,8x7,3	Ø12xØ6,8x7,3 bush with flange	4	CASQUI-1A---750
5		Tornillo M5x16 Ø11 ISO 7380	M5x16 Ø11 ISO 7380 allen screw	4	TORNI-I7380-493
6		Tapon M5 ISO 7380	M5 ISO 7380 cap	4	TAPON-----85

KTM 1290 SUPERDUKE GT '19-

INSTRUCCIONES DE MONTAJE - MOUNTING INSTRUCTIONS - MONTAGEANLEITUNG

1

**DISASSEMBLY
DESMONTAJE**

A Tornillería original
Original screw

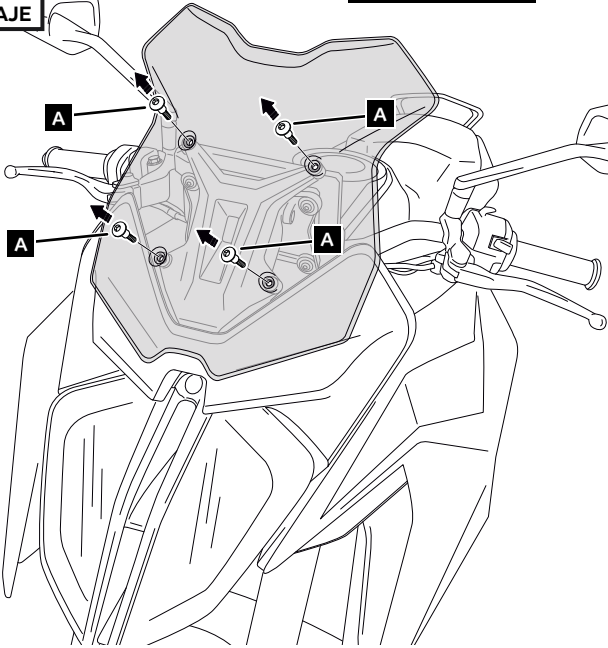

2

**ASSEMBLY
MONTAJE**

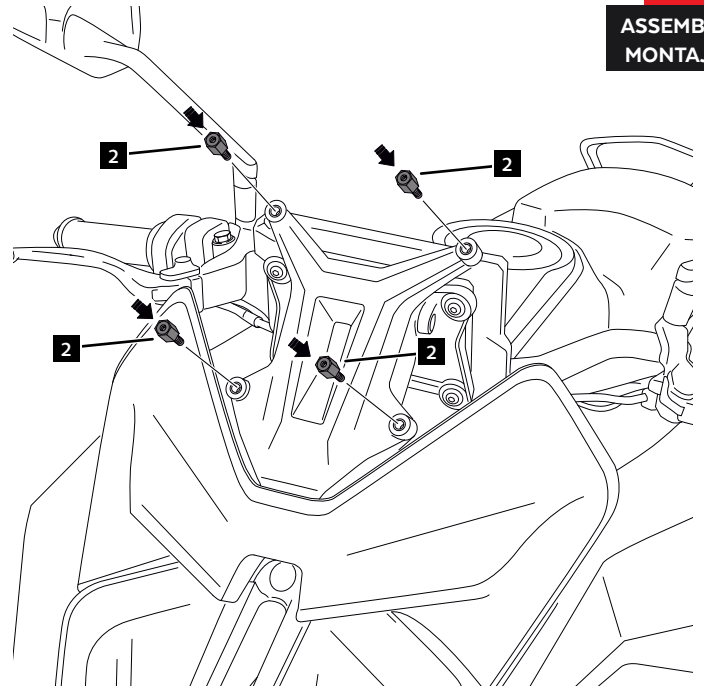

3

**ASSEMBLY
MONTAJE**

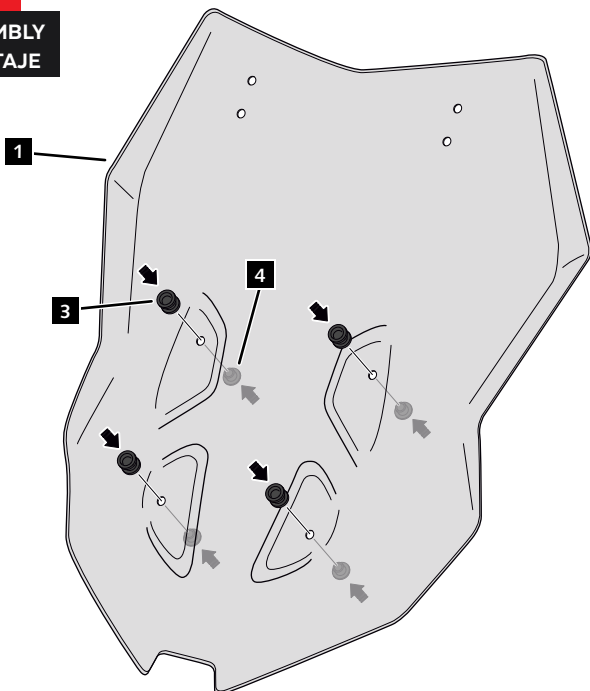

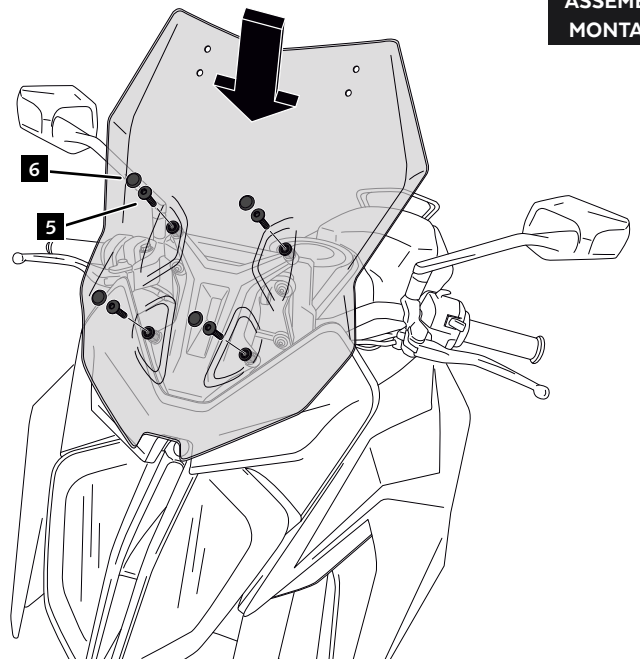

4

**ASSEMBLY
MONTAJE**

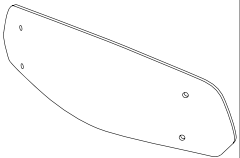
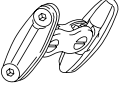

KTM 1290 SUPERDUKE GT '19-

INSTRUCCIONES DE MONTAJE - MOUNTING INSTRUCTIONS - MONTAGEANLEITUNG

ID.	PIEZA/PART	DESCRIPCIÓN	DESCRIPTION	QTY.	REF.:
7		Visera N°3	Visor N°3	1	6270HM3
8		Mecanismo multiregurable	Multi-adjustable mechanism	2	6271N
9		Tapeta	Cap	4	CONJU-VISERA-75
10		Tornillo rosca plástico Ø6 x14mm	Ø6x 14mm Plastic thread fastener	8	TOZN00M60000258

5

**ASSEMBLY
MONTAJE**

