

HONDA CB750 HORNET '25-

M O U N T I N G I N S T R U C T I O N S

REF 22427

NAKED FRONTAL SPOILERS



1 Person



10 min



EASY

ALLEN



N° 3
N° 4



ID.	PIEZA/PART	DESCRIPCIÓN	DESCRIPTION	QTY.	REF.:
1		Alerón Frontal Naked	Naked Frontal Spoiler	1	22427J/N/CM3
2		Soporte	Support	1	SOPOR1P1--22427
3		Tope de goma Ø10,5 x Ø7,9mm	Ø10,5 x Ø7,9mm bumper foot	4	TAPON-----95
4		Arandela de goma Ø4,5 x Ø11 x 2mm	Ø4,5 x Ø11 x 2mm rubber washer	2	ARAND-EPDM--722
5		Tornillo M5x12 DIN7991	M5x12 DIN7991 allen screw	2	TORNI-D7991-611
6		Tapón tornillo M5 DIN7991	M5 DIN7991 screw Cap	2	TAPON-----92
7		Tornillo Allen M5x16 Ø11 ISO 7380	M5x16 Ø11 ISO 7380 Allen screw	2	TORNI-I7380-493

HONDA CB750 HORNET '25-

INSTRUCCIONES DE MONTAJE - MOUNTING INSTRUCTIONS - MONTAGEANLEITUNG

1

**DISASSEMBLY
DESMONTAJE**

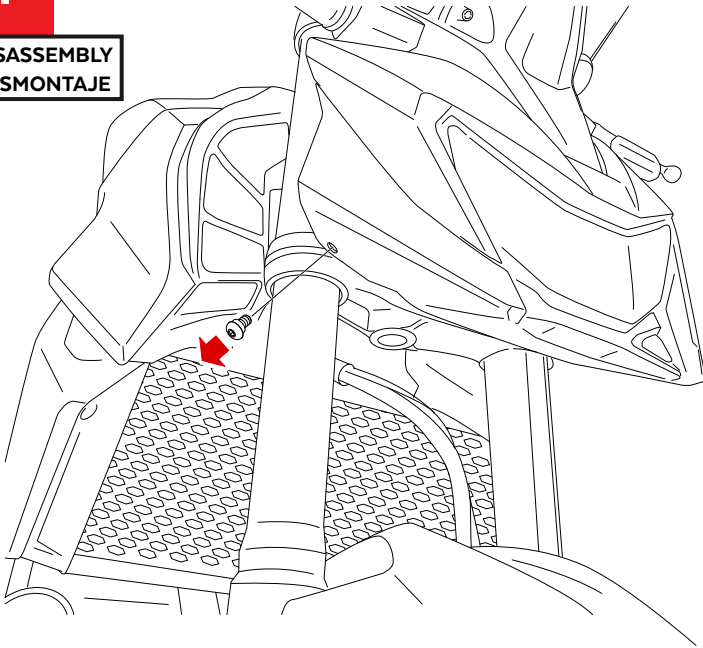

REALIZAR LA MISMA OPERACIÓN PARA EL LADO IZQUIERDO
PERFORM THE SAME OPERATION FOR THE LEFT SIDE

2

**ASSEMBLY
MONTAJE**

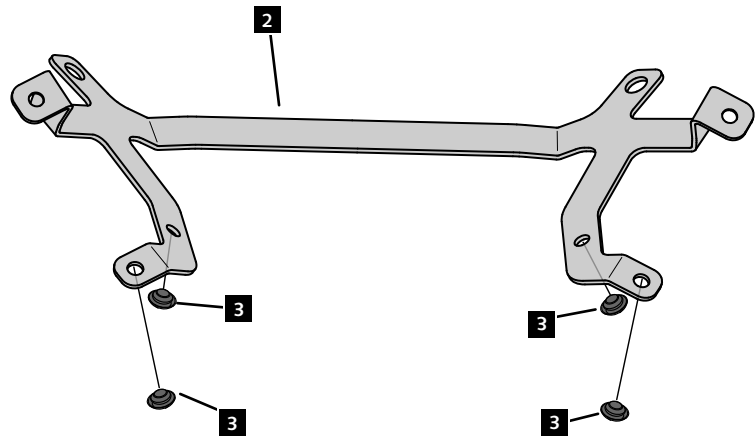

3

**ASSEMBLY
MONTAJE**

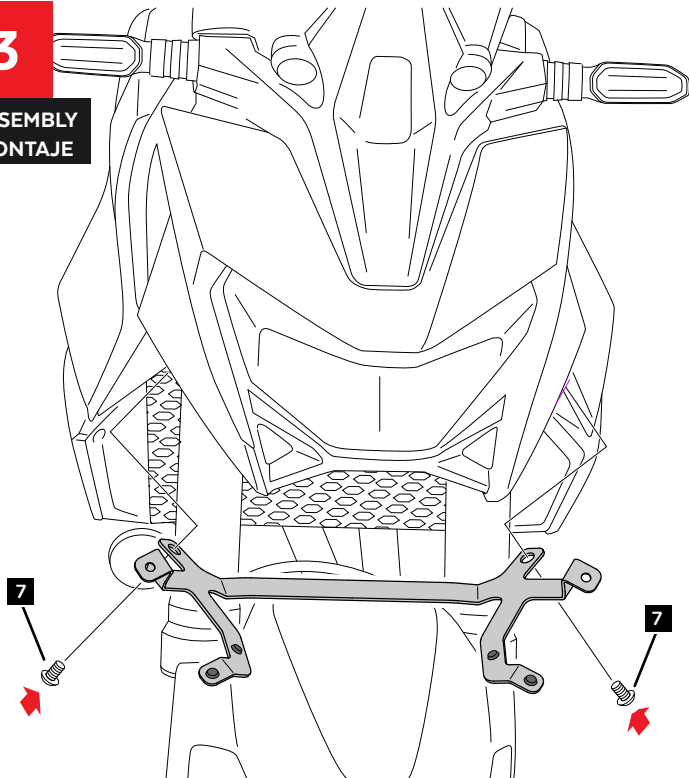

4

**ASSEMBLY
MONTAJE**

